



...in the CLASSIC tradition



BARTH Motorhomes excel in form and function . . . in safety and performance . . . and in value. Although "quality" is claimed by all coach manufacturers, Barth is recognized within the industry for unexcelled engineering, structure, materials, and craftsmanship. To you who rightfully expect the best, comparison will prove your choice of a Barth Motorhome as most discerning. As with certain fine automobiles, a Barth Motorhome reflects its owner's good taste and judgement. Your knowledgeable Barth Dealer will assist you most reliably in your selection of coach size and equipment to best serve your needs. We at Barth depend on your total satisfaction.



U.S. PATENT 3,282,603

M. D. Umbaugh
President



Today's Most Wanted Motor Home

Most wanted quality . . . most popular size. This may well be your choice. If "yes" . . . you would be investing in today's very best motor home value. This is the year you should award yourself a Barth!

TIME-PROVEN quality based on Barth's patented design and construction assures you the safety, performance and unique styling that set Barth apart from the "boxy" crowd. All aluminum frame, and exterior; and superbly integrated chassis features make Barth the automotive engineers' choice among all recreational vehicles.

BEAUTIFUL is the word for Barth coach interiors. The commanding posture-perfect pilot and co-pilot seating and the decorator-styled, color coordinated furnishings will win your favor. Comfort when under way, and luxurious relaxation when living-in, are unsurpassed.

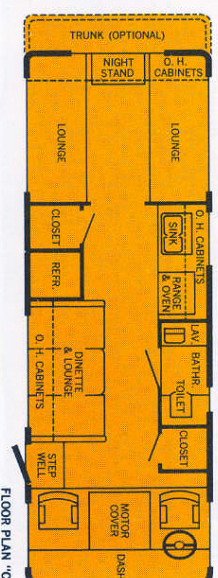
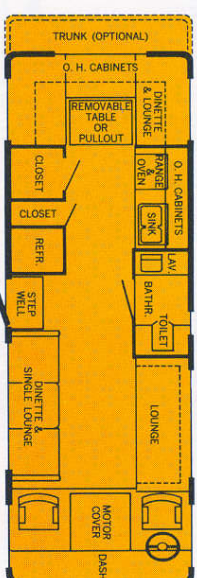
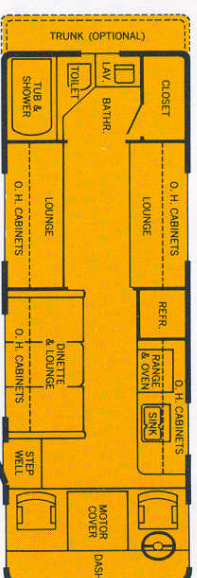

Optimum Spaciousness

With a length of 28 feet, this Barth Motor Coach affords roominess for extended vacations, retirement trips, and for larger families. The ease with which the Barth performs on the road will be appreciated with your first driving experience. If there is a motor home in your future, make it a Barth now . . . with quality that fulfills your highest expectations.

FLOOR PLANS available with the 28' and 29' models offer a great variety of arrangements for any need. Many years of Barth experience are reflected in these enjoyable livable plans.

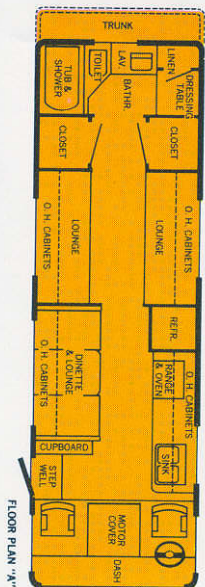

FURNISHINGS in Barth coaches are richly color-coordinated with total decor supervised by professional decorators. Inside and out, Barth styling exemplifies good taste.

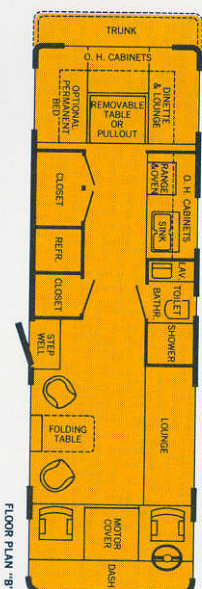

CONSTRUCTION details of these Barth units are recognized within the RV industry as exceptional in materials and craftsmanship. This results in greater total value to owners.

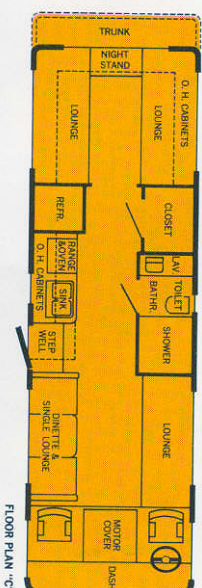



Ultimate Luxury

Eventually this Barth had to be made available. Into it are built the finest features possible in a luxury motor home of classic beauty and livability in 29' and 32' models. Now you can own one.

the
29' and
32' B A R T H

LIMITED production adds to the desirability of acquiring one of these high-achievement luxury coaches. Pride of ownership is respected as well merited.

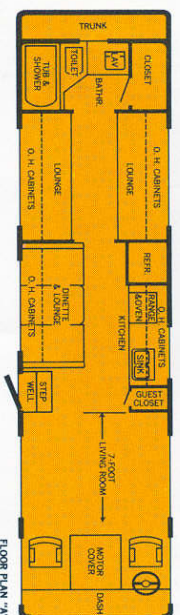

ROADABILITY is unexcelled with tandem rear axles. These, with individually sprung front suspension, provide superb driving ease and comfort.

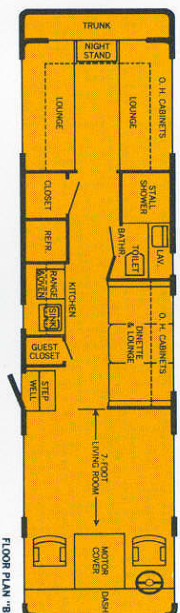

LAND YACHTING is the word for the living-travel experiences afforded with these most elegant vehicles. Simply stated . . . if you want the very best, this is your Barth.

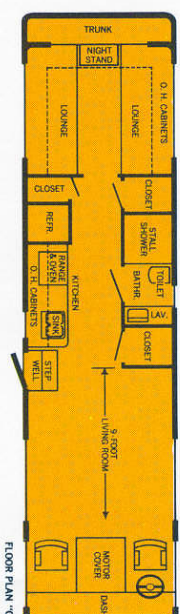



OUTFITTING of the 22' Barth includes the greatest list of standards and available options anyone could possibly want. The two floor plans afford choice of traffic patterns inside, which ideally answer any needs. A most practical 4-sleeper, or a most spacious motor home for two, this Barth also offers exceptional mobility for every kind of travel, and in-and-out base camp touring.

LIVELY, fleet and tractable describe the ease with which you get around. This one is generously powered with fantastic driving response, as are all Barth vehicles. Go where you want, when you want with Barth . . . in the finest of living accommodations and comforts.

In Answer To Growing Demand

With all its superb Barth features, the 22' model is the choice of fast-growing numbers of smaller families, couples of all ages, sportsmen and commercial owners. Comparison of this size of coach wins top rating for Barth with all who see it.

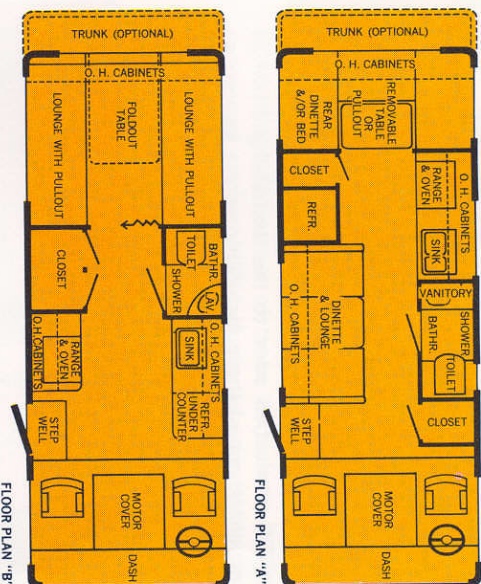



Newest And Finest Of All Deluxe Compacts

Barth salutes "first owners" with this lower cost, 19' super motor home. All the essential automotive and coach features are incorporated, and in no way is quality compromised. Each appliance that goes into this model, although sometimes smaller, is equal to that in the larger units. The list of standard and optional features is most gratifying.

COMPACT may be a misleading description of the 19' Barth. Living elements are so well arranged that even the photos below show the remarkably efficient "living room" achieved in this Barth coach.

ONE FLOOR PLAN is engineered to permit maximum livability and provide room for the most generous equipment outfitting. If you are looking for today's finest value in luxury living-travel, and your sleeping requirement is two to four adults, this is your Barth.

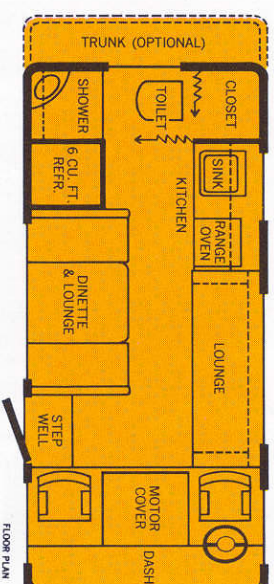



STANDARD FEATURES

- Chevrolet Wheel Base (Fr. to R. Axle)
- Chevrolet V-8 Engine
- Transmission
- Power Brakes
- Power Steering
- Heater & Defrosters
- Pilot & Co-Pilot Seats
- Safety Glass
- Exterior Mirrors
- Potable Water Tank
- Seat Belts
- Cooking Appliances
- Range Accessories
- Refrigerator
- Automatic Gas Furnace
- Electrical Hot Water
- 12V Appliance, Basic
- 110V Appliance Outlets
- Interior Lighting
- Exterior Lighting
- Toilet
- Holding Tank
- Bathroom
- LP Gas Supply
- Ventilation
- Utility Hookups
- Gasoline
- Carpet & Drapes
- Cabinetry
- Interior Decor

VEHICLE SPECIFICATIONS

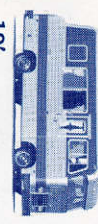

19'

Chev. 125" W'base
350 Cu. In. (C.I.D.)
Turbo Hydromatic
Fr. Disc & Dual Vac.
Adj. Wheel Tilt
Fresh Air, 2 Blowers
Adj.; Head & Arm Rests
Tinted, Heat Absorbing
2 West Coast Type
30-Gal. Demand Pump
With Shoulder Harness
4-Burner Range & Oven
Hood, Light & Fan
7 Cu. Ft. AC/DC
1 or 2; 30,000 BTU
6-Gal. Gas-fired
12V Converter
2 With Lighters
2 Kitchen & Bath
12 Volt
Approved & Backups
Marine, Flush type
38 Gallons
Shower & Lavatory
42-lb. Built-in
3 Roof Vents & Dash
Water-Sewer — 110V
30 Gallons
Shag Carp.; Lined Drapes
Hand Fin. Hardwood
Color Coordinated

Width, o.a., 93"
Height, o.a., 112"
Int. Height, 78"
Body in-
terlocking aircraft-
riveted .040 Alcoa
Tonecoat aluminum
over extruded alumi-
num frame. One-piece
aluminum roof. Rear
axle ratio, 4.10. Tires,
7.50 x 16, 8 ply.

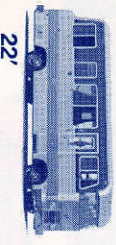

22'

Chev. 159" W'base
454 Cu. In. (C.I.D.)
Turbo Hydromatic
Fr. Disc & Dual Vac.
Adj. Wheel Tilt
Fresh Air, 2 Blowers
Adj.; Head & Arm Rests
Tinted, Heat Absorbing
2 West Coast Type
30-Gal. Demand Pump
With Shoulder Harness
4-Burner Range & Oven
Hood, Light & Fan
7 Cu. Ft. AC/DC
30,000 BTU, Ducted
6-Gal. Gas-fired
12V Converter
2 With Lighters
2 Kitchen & Bath
12 Volt
Approved & Backups
Marine, Flush type
58 Gallons
Tub &/or Shower & Lav.
42-lb. Built-in
3 Roof Vents & Dash
Water-Sewer — 110V
60 Gallons
Shag Carp.; Lined Drapes
Hand Fin. Hardwood
Color Coordinated

Width, o.a., 93"
Height, o.a., 112"
Int. Height, 78"
Body in-
terlocking aircraft-
riveted .040 Alcoa
Tonecoat aluminum
over extruded alumi-
num frame. One-piece
aluminum roof. Rear
axle ratio, 4.10. Tires,
7.50 x 16, 8 ply.



25'

Chev. 159" W'base
454 Cu. In. (C.I.D.)
Turbo Hydromatic
Fr. Disc & Dual Vac.
Adj. Wheel Tilt
Fresh Air, 2 Blowers
Adj.; Head & Arm Rests
Tinted, Heat Absorbing
2 West Coast Type
30-Gal. Demand Pump
With Shoulder Harness
4-Burner Range & Oven
Hood, Light & Fan
7 Cu. Ft. AC/DC
30,000 BTU, Ducted
6-Gal. Gas-fired
12V Converter
2 With Lighters
2 Kitchen & Bath
12 Volt
Approved & Backups
Marine, Flush type
58 Gallons
Tub &/or Shower & Lav.
85-lb. Built-in
3 Roof Vents & Dash
Water-Sewer — 110V
60 Gallons
Shag Carp.; Lined Drapes
Hand Fin. Hardwood
Color Coordinated

Width, o.a., 93"
Height, o.a., 112"
Int. Height, 78"
Body in-
terlocking aircraft-
riveted .040 Alcoa
Tonecoat aluminum
over extruded alumi-
num frame. One-piece
aluminum roof. Rear
axle ratio, 4.10. Tires,
7.50 x 16, 8 ply.

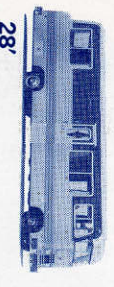

28'

Chev. 195" W'base
454 Cu. In. (C.I.D.)
Turbo Hydromatic
Fr. Disc & Dual Vac.
Adj. Wheel Tilt
Fresh Air, 2 Blowers
Adj.; Head & Arm Rests
Tinted, Heat Absorbing
2 West Coast Type
30-Gal. Demand Pump
With Shoulder Harness
4-Burner Range & Oven
Hood, Light & Fan
7 Cu. Ft. AC/DC
30,000 BTU, Ducted
6-Gal. Gas-fired
12V Converter
2 With Lighters
2 Kitchen & Bath
12 Volt
Approved & Backups
Marine, Flush type
58 Gallons
Tub &/or Shower & Lav.
85-lb. Built-in
3 Roof Vents & Dash
Water-Sewer — 110V
60 Gallons
Shag Carp.; Lined Drapes
Hand Fin. Hardwood
Color Coordinated

Width, o.a., 93"
Height, o.a., 112"
Int. Height, 78"
Body in-
terlocking aircraft-
riveted .040 Alcoa
Tonecoat aluminum
over extruded alumi-
num frame. One-piece
aluminum roof. Rear
axle ratio, 4.10. Tires,
7.50 x 16, 8 ply.

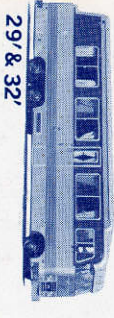

29' & 32'

Chev. 207" or 243" W'base
454 Cu. In. (C.I.D.)
Turbo Hydromatic
Fr. Disc & Dual Vac.
Adj. Wheel Tilt
Fresh Air, 2 Blowers
Adj.; Head & Arm Rests
Tinted, Heat Absorbing
2 West Coast Type
30-Gal. Demand Pump
With Shoulder Harness
4-Burner Range & Oven
Hood, Light & Fan
7 Cu. Ft. AC/DC
1 or 2; 30,000 BTU
6-Gal. Gas-fired
12V Converter
2 With Lighters
2 Kitchen & Bath
12 Volt
Approved & Backups
Marine, Flush type
58 Gallons
Tub &/or Shower & Lav.
85-lb. Built-in
3 Roof Vents & Dash
Water-Sewer — 110V
60 Gallons
Shag Carp.; Lined Drapes
Hand Fin. Hardwood
Color Coordinated

Width, o.a., 93"
Height, o.a., 115"
Int. Height, 79"
Body in-
terlocking aircraft-
riveted .040 Alcoa
Tonecoat aluminum
over extruded alumi-
num frame. One-piece
aluminum roof. Rear
axle ratio, 4.10. Tires,
7.50 x 16, 8 ply. Tan-
dem axles with air
suspension.

Manufactured by
BARTH, INC.
Mifflord, Indiana 46542
Telephone: (219) 658-4147

Your Barth Dealer will be glad to provide details of the many standard as well as optional features available with your choice of any Barth Motorhome.

V & M Camper Center Inc.
32200 Lorain Road
North Ridgeville, Ohio 44070

The Barth 29' and 32' models also include as standard features: a 5000W generator with heavy duty battery, 13,000 BTU or more air conditioning, complete sound system, control panel, privacy curtain, insulated holding tank, and trunk.

Specifications are subject to change without notice.

Form 72-9E